

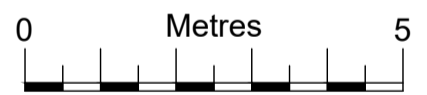

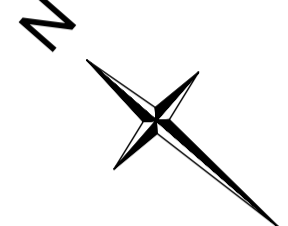

Barnwood Road

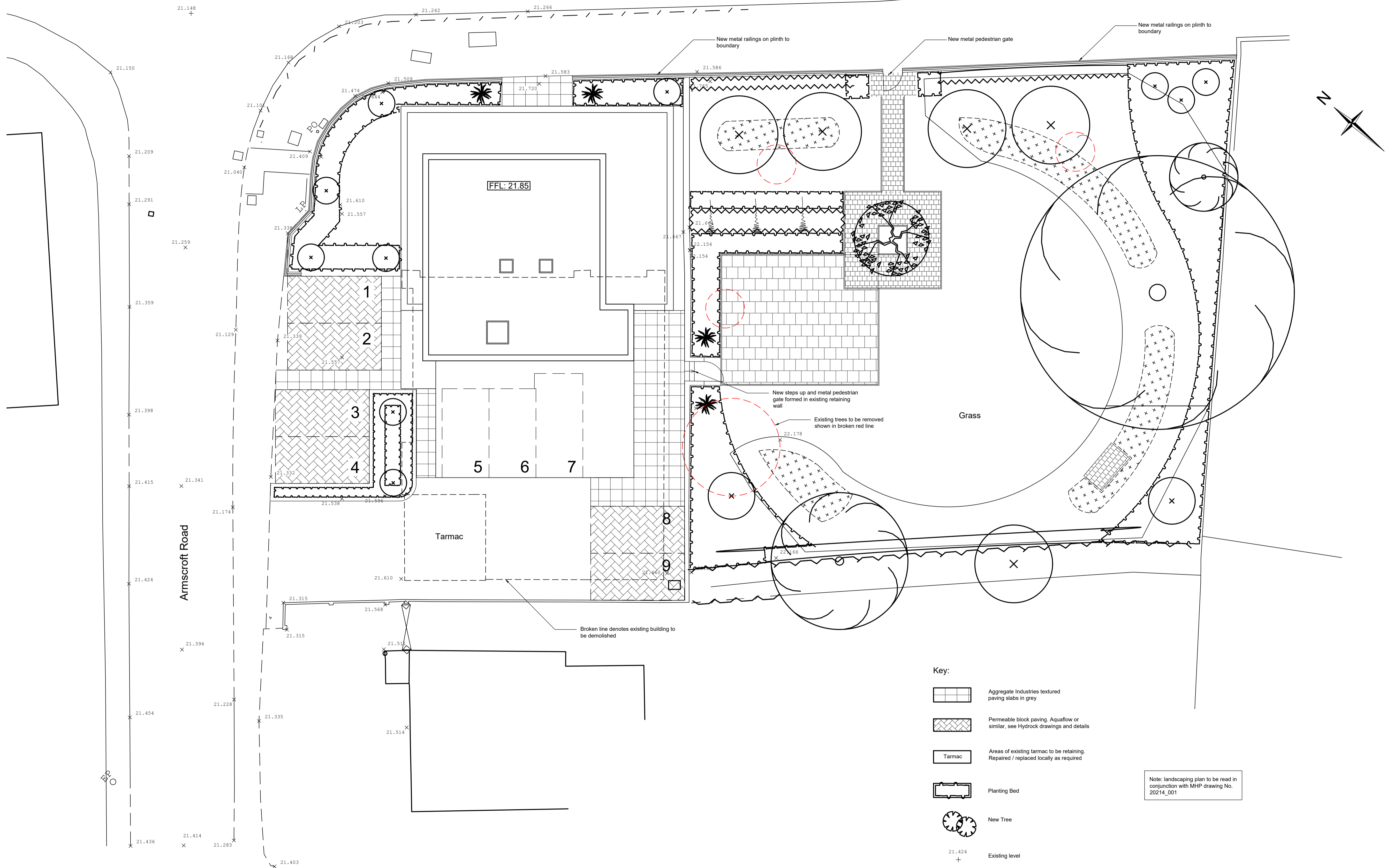
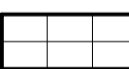

Key:

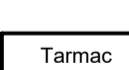
-  Aggregate Industries textured paving slabs in grey
-  Permeable block paving, Aquaflo or similar, see Hydrock drawings and details
-  Tarmac
-  Planting Bed
-  New Tree
-  Existing level
-  Proposed new level

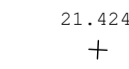
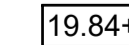
Note: landscaping plan to be read in conjunction with MHP drawing No. 20214_001

Broken line denotes existing building to be demolished

New steps up and metal pedestrian gate formed in existing retaining wall
Existing trees to be removed shown in broken red line

New metal railings on plinth to boundary

New metal pedestrian gate

New metal railings on plinth to boundary

FFL: 21.85

Tarmac

Grass

Armscroft Road

Proposed Apartments
Armscroft Road / Barnwood Road
Gloucester
Glos

Site Plan
As Proposed

Scale 1:100 @ A1, 1:200 @ A3

Date June 2020

Dwg. No. 21968 / 16 B



3 Tebbit Mews
Winchcombe Street
Cheltenham
Glos
GL52 2NF
t 01242 521608
e admin@clivepetcharchitects.co.uk
www.clivepetcharchitects.co.uk